

Track Record

HVAC & R Systems Integrator

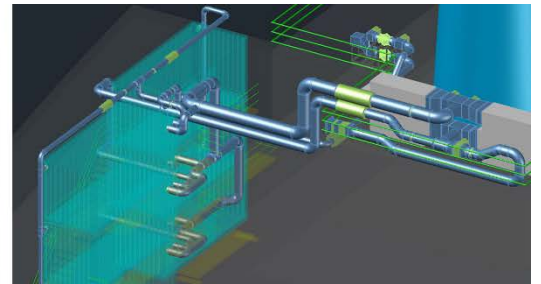

Air Conditioning, Refrigeration, Electrical, Systems Integration



Engineering & Design, Installation Supervision, Testing & Commissioning



ID	Task Name	Duration	Start	Finish	Qtr 3, 2013		Qtr 4, 2013			Qtr 1, 2014			Qtr 2, 2014			Qtr 3, 2014			Qtr 4, 2014			Qtr 1, 2015		
					Jul	Aug	Sep	Oct	Nov	Dec	Jan	Feb	Mar	Apr	May	Jun	Jul	Aug	Sep	Oct	Nov	Dec	Jan	Feb
1	Project Schedule	434 days	Tue 1/06/13	Tue 2/05/15																				
2	Project Mobil & Set Up	3 days	Tue 1/06/13	Mon 0/06/13																				
3	HVAC System Basic Design & Documentation	16 days	Tue 1/06/13	Wed 4/06/13																				
4	Project Documentation	10 days	Tue 1/06/13	Wed 4/06/13																				
5	Master Document Register	5 days	Tue 0/06/13	Mon 1/06/13																				
6	Project Execution Plan	5 days	Tue 0/06/13	Mon 1/06/13																				
7	IEP	10 days	Tue 1/06/13	Wed 4/06/13																				
8	Basic Design	300 days	Tue 1/06/13	Mon 0/06/14																				
9	Mechanical Design	300 days	Tue 1/06/13	Mon 0/06/14																				
10	Specifications & Philosophies	10 days	Tue 1/06/13	Mon 2/12/13																				
11	Final Submittals	120 days	Tue 1/06/13	Mon 3/06/14																				
12	Living Quarters	125 days	Tue 1/06/13	Mon 3/06/14																				
13	Final Load & Air Flow Calculations for LO	6 days	Tue 1/06/13	Mon 2/06/13																				
14	HVAC Single Line Diagrams (SFDs) for LO	6 days	Tue 2/06/13	Mon 4/11/13																				
15	P&ID Drawings for LO	14 days	Tue 2/06/13	Mon 30/12/13																				
16	D & I D Drawings for LO	14 days	Tue 2/06/13	Mon 30/12/13																				
17	Pneumatic Diagram	5 days	Tue 3/12/13	Mon 3/01/14																				
18	Equipment list	3 days	Tue 3/12/13	Mon 3/01/14																				
19	Hull	120 days	Tue 1/06/13	Mon 3/06/14																				
20	Heat Load & Air Flow Calculations for Hull	6 days	Tue 1/06/13	Mon 2/10/13																				
21	HVAC Single Line Diagrams (SFDs) for Hull	6 days	Tue 2/06/13	Mon 4/11/13																				
22	P&ID Drawings for Hull	14 days	Tue 2/06/13	Mon 30/12/13																				
23	D & I D Drawings for Hull	14 days	Tue 2/06/13	Mon 30/12/13																				
24	Pneumatic Diagram	5 days	Tue 3/12/13	Mon 3/01/14																				
25	Equipment list	5 days	Tue 3/12/13	Mon 3/01/14																				
26	Submittal submissions	255 days	Tue 2/06/13	Mon 1/06/14																				



Procurement, Project Management, Manufacture, Service and Maintenance

Track Record

Year	Client	Location	Facility
2020	Woodside Energy	Australia	Karratha Gas Plant
2020	Clough Amec	Timor	Bayu Undan
2020	Inpex	Australia	Ichthys CPF Explorer
2020	Inpex	Australia	Ichthys FPSO Venturer
2019	Worley	Australia	Karratha Gas Plant
2018	Shell	Australia	Prelude FLNG
2018	Inpex	Australia	Ichthys CPF Explorer
2018	Inpex	Australia	Ichthys FPSO Venturer
2018	Woodside Energy	Australia	Goodwyn A
2018	Woodside Energy	Australia	Karratha Gas Plant
2018	Equinor	Norway	Martin Linge
2017	Sakhalin Energy	Russia	Piltun AB
2017	Sakhalin Energy	Russia	Lunskoye A
2017	Chevron	Australia	Wheatstone Gas Plant
2017	Woodside Energy	Australia	Heliport
2017	Woodside Energy	Australia	King Bay Supply Base
2016	Inpex	Korea	Ichthys CPF Explorer
2016	Inpex	Korea	Ichthys FPSO Venturer
2015	Woodside Energy	Australia	Karratha Gas Plant
2015	Clough	Australia	Wheatstone Platform
2014	Total	Sweden/Norway	Martin Linge
2014	Apache Energy	Singapore	Ningaloo Vision FPSO
2014	Total	Nigeria	Ofon OFP2 Topsides
2014	Conoco Philips	Timor	Bayu Undan
2013	Sakhalin Energy	Russia	Lunskoye A Platform
2013	Woodside Energy	Australia	NRB Platform
2013	Woodside Energy	Australia	NRB Platform
2012	Woodside Energy	Singapore	Vincent FPSO
2012	Woodside Energy	Australia	Northern Endeavour FPSO
2012	Chevron	Australia	Wheatstone LNG Plant Substations
2012	Conoco Phillips	Australia	Bayu Undan
2012	Keppel Shipyard	Singapore	Navy Fast Patrol Boat
2012	Apache Energy	Australia	Stag Platform
2012	Woodside Energy	Australia	Karratha LNG Gas Plant
2011	AGIP KCO	Kazakhstan	Kashagan A & D Island
2011	Oilsearch	PNG	Kumul Platform
2010	BW Offshore	Singapore	Nexus 1 (OSX) FPSO
2009	Woodside Energy	Australia	North Rankin 2
2008	Woodside Energy	Australia	Pluto LNG Plant Phase 1,2 & 3
2008	Total	Korea	OFP2 Topsides
2008	Adma Opco	Korea / UAE	USGIF Umm Shaif

Year	Client	Location	Facility
2007	Petrofac	Kazakhstan	Karachaganak
2007	Conoco Philips	Indonesia	North Belut
2007	BW Offshore	Korea	Nexus FPSO
2007	Total	Korea / Angola	Dalia FPSO Toppersides
2007	Conoco Philips	Singapore / Indonesia	Kerisi FPSO
2007	ONGC	Korea / India	Vasai
2006	Sakhalin Energy	Russia	Orlan Platform
2005	Freeport	Indonesia	Highlands Kainantu
2005	Shell	Nigeria	Sea Eagle FPSO
2004	Woodside Energy	Australia	Goodwyn A
2003	Clough	Pakistan	Sawan Gas Field
2003	Total	Thailand	Hazira Well Head Platform
2002	Conoco Philips	Indonesia	Bayu Undan Well Head
2001	Exxon Mobil	Australia	Wandoo B
2001	Woodside Energy	Korea / Singapore	Northern Endeavour
2000	Shell	Korea / Nigeria	EA FPSO
1999	ONGC	Korea / India	BHN Platform
1999	Woodside Energy	UAE	Cossack Pioneer FPSO
1999	Tenex	Australia	HMAS Westralia
1998	Harland & Wolff	Northern Ireland	Global Marine Drill Ships Jack Ryan & CR Luigs
1998	MIPO	Korea	Pride Drill Ships Angola & Africa
1997	Conoco	Korea	Pathfinder, Frontier, Millenium & Discovery Drillships
1997	Total	Singapore	Bongkot Platform
1996	MIPO	Korea	PGS Ramform Banff FPSO
1994	Clough	Pakistan	Dhodak Gas Plant

1984 – 1993 Various other projects. References available upon request.

Process Summary

Every project requires specialist skillsets selected to match client & project requirements. For HVAC & R, Electrical and Instrumentation Integration scopes MizCo typically receives RFQs for engineering & procurement or supply of specialist labour to ensure a project is delivered according to client expectations and in accordance with industry and regulatory requirements.

MizCo has the capability to accept scope(s) of work in accordance with client Oil & Gas HVAC project requirements and project specifications.

On projects we are typically engaged to carry out Engineering & Design, Project Management, Procurement and Manufacture, Installation Supervision and Commissioning, Service and Maintenance and ongoing Spare Parts support.

Some examples for both Greenfield and Brownfield sites include:

- Design of HVAC & R Mechanical and Electrical, Instrumentation systems
- Compliance with project specifications
- Compliance with classification society regulations
- Compliance with international standards such as ISO 15138
- Procurement & manufacture of equipment
- Provision of specialist personnel for offshore and onshore works
- Commissioning of systems
- Ongoing Service and Maintenance

We have the in-house expertise to co-ordinate and manage client requests and deliver according to expectation.

MizCo typically utilises client approved Supplier Document Requirements List (SDRL) or Vendor Document Requirements Lists (VDRL) along with project management milestones and Key Performance Indicators (KPI's) to manage and control projects.

Project Selection & Personnel Competency

MizCo's selection rationale is directed by a set of predetermined objectives that evaluate and combine facts with good judgement. We recognise the business acumen that is required to keep a business competitive and up to date with today's engineering technologies.

MizCo's focused approach is on high quality engineering and labour support and this ensures we consistently deliver according to client expectations. Our HVAC Electrical and Instrumentation Systems Integration design, manufacturing expertise and site commissioning professionalism is valued and recognised both locally and overseas.

Selection rationale for tendered project works include geographic region, applicable codes and standards, scope of work, adequacies of staff and facilities, time commitments and competing demands.

A specific project plan will be developed for client comment and approval. For rotational commissioning works these are typically programmed in advance with assigned personnel to ensure suitable skillsets are allocated and available as per client request and purchase order.

All personnel are competent and experienced for the assigned position and hold the necessary licenses to carry out their duties.